

# RG-145-1 & RG-145-2



EMERGENCY AIRCRAFT BATTERY



RG-145-2 features an INTERNAL DC HEATER

**TSO AUTHORIZED**

## Standby and Emergency Power

Concorde's Emergency and Standby batteries are valve regulated sealed recombinant gas (RG<sup>®</sup>), constructed with advanced lead acid and absorbed glass mat (AGM) technology.

Designed to float directly on the DC buss, there is no need for a dedicated charger. The batteries are self regulating and can accept high inrush current for fast recovery.

- Maintenance free
- Constructed with non removable vent valves – no addition of electrolyte or water required
- Aerobatic: Non spillable at any altitude or attitude
- Factory tested to assure airworthiness
- Shipped fully charged and ready to install
- RG<sup>®</sup> Series is classified as unrestricted for land, sea or air transportation
- Available through a professional network of worldwide distributors

### RG-145-1/RG-145-2 Specifications

Voltage	24 Volts
Rated Capacity C <sub>1</sub>	17 AH
Maximum Weight	42.5 LB / 19.7 KG

Specifications are subject to change without notice

### IEC Rated for Peak Power (IPP) & 15 Second Power Rating (IPR)

IPP	IPR	IPP	IPR	IPP	IPR
At 23° C (74° F)		At -18° C (0° F)		At -30° C (-22° F)	
900 A	625 A	600 A	425 A	450 A	300 A

Rated in accordance with International Standard 60952-1

### Features

RG-145-2 Battery features an Internal DC Heater

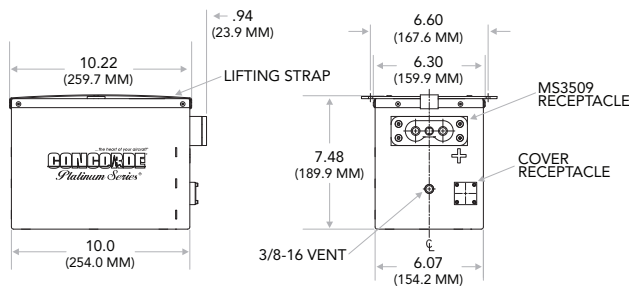

RG-145-1

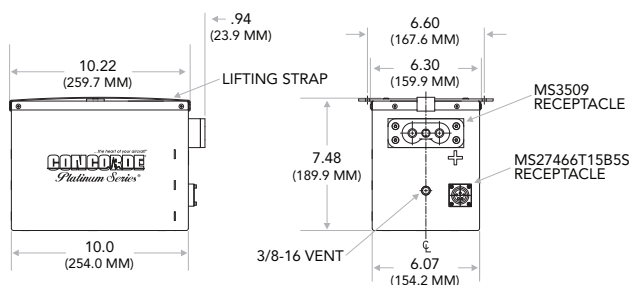

RG-145-2

### Concorde Battery Corporation

2009 San Bernardino Road, West Covina, CA 91790 USA  
Phone 626-813-1234 | Fax 626-813-1235

ISO 9001 + AS9100

The data/information contained herein has been reviewed & approved for general release on the basis that this document contains no export controlled information.

[www.concordebattery.com](http://www.concordebattery.com)